

© COPYRIGHT OF THIS DRAWING IS RESERVED BY DBFL CONSULTING ENGINEERS. NO PART SHALL BE REPRODUCED OR TRANSMITTED WITHOUT THEIR WRITTEN PERMISSION.

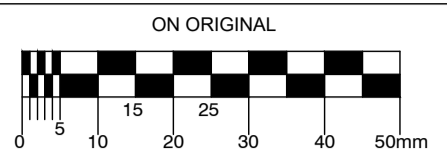

NOTES:  
LEGEND

- SITE BOUNDARY
- 25mm HIGH RAISED KERB
- PROPOSED ROAD CONSTRUCTION
- PROPOSED FOOTPATH
- EXISTING ROAD
- EXISTING FOOTPATH
- EXISTING CYCLE TRACK
- PROPOSED SHARED SURFACE
- PROPOSED REINFORCED GRASS (NETLON ADVANCED TO LANDSCAPE ARCHITECTS SPECIFICATION)
- PROPOSED TACTILE
- PROPOSED ROAD LEVELS
- PROPOSED ROAD GRADIENT
- BELISHA BEACON
- BASEMENT FOOTPRINT

7.5t Panel Van  
 Overall Length 7.210m  
 Overall Width 2.44m  
 Overall Body Height 2.54m  
 Min Body Ground Clearance 1.865m  
 Track Width 1.865m  
 Lock-to-lock time 4.30s  
 Curb to Curb Turning Radius 7.400m

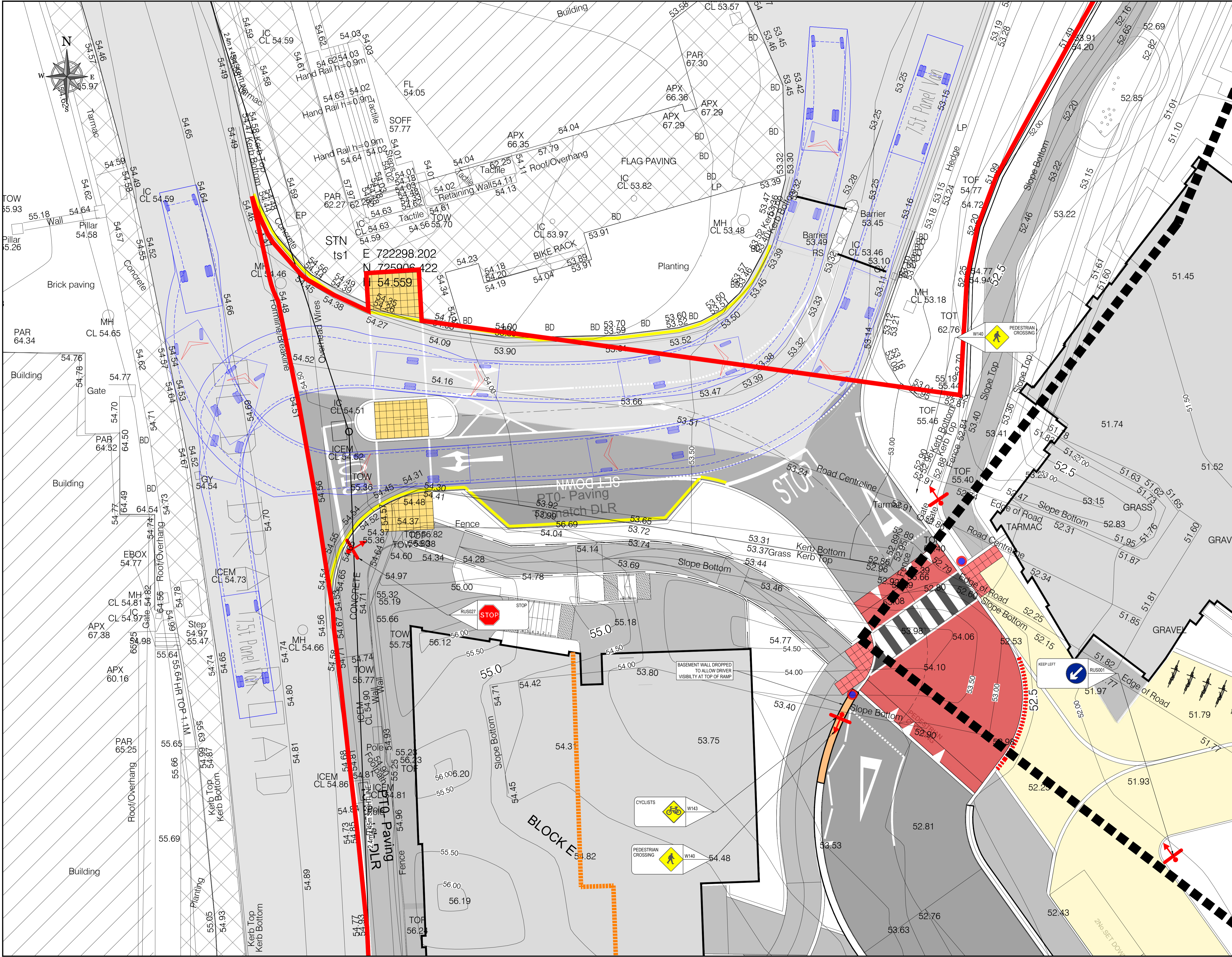

P3	22-11-21	FOR SHD APPLICATION	JVS	BK
P2	23-04-21	FOR PRE-APPLICATION MEETING	JVS	BK
P1	03-12-19	FOR ASP APPLICATION	JVS	BK
REV	DATE	DESCRIPTION	BY	CHKD
SUITABILITY		S2 - FOR INFORMATION		

PLANNING			
DESIGNED	BK	PREPARED	PJJC
DATE	JAN 2019	CHECKED	DJR

**DBFL**  
 DBFL Consulting Engineers  
 DUBLIN OFFICE: Ormond House, Upper Ormond Quay, Dublin 7, Ireland. PHONE: +353 1 400 4000 FAX: +353 1 400 4050  
 WATERFORD OFFICE: Unit 2, The Chandery, 1-2 O'Connell Street, Waterford, Ireland. PHONE: +353 51 309 500 FAX: +353 51 844 913  
 EMAIL: info@dbfl.ie SITE: www.dbfl.ie

PROJECT  
**PROPOSED DEVELOPMENT AT CORNELSCOURT**

DRG. TITLE  
**SITE ENTRANCE**

CLIENT  
**CORNEL LIVING LIMITED**

SCALE  
1:100 @A1

FILE REF.  
180208-DBFL-XX-XX-DR-C-2001

DRG. NO.  
180208-DBFL-XX-XX-DR-C-2002 P3